



# Central States Sentry™ Combo Latch

A more secure option  
for your doors!

[www.centralstatesco.com](http://www.centralstatesco.com)



# Central States Sentry™ Combo Latch



Designed to accept pad locks or cylinder locks on the same latch, or transition to a keyed bezel lock without the need to replace the latch, providing flexibility as security needs evolve.

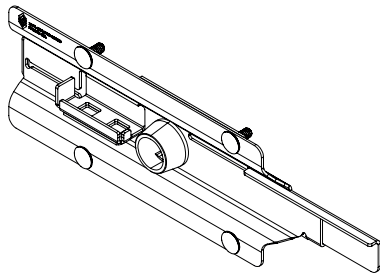
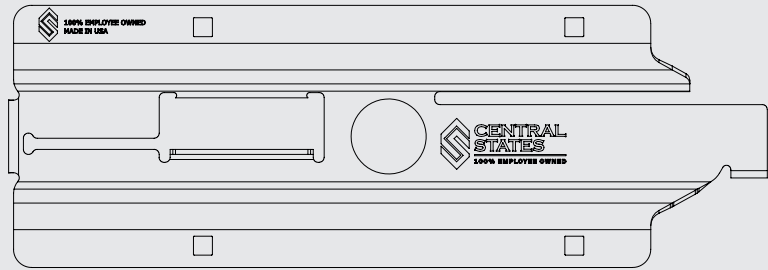

Combo Latch

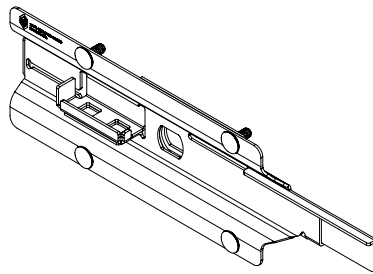

Combo Latch No Bezel

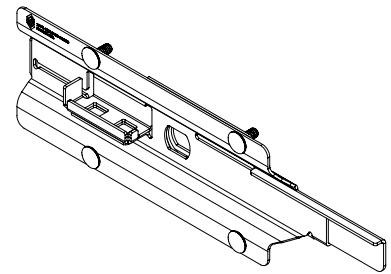

Masterlock Only Latch

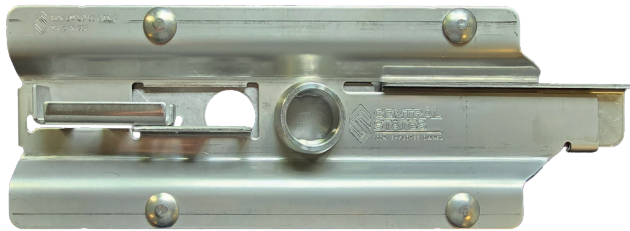

Stainless-Steel (standard offering)



Yellow Zinc (optional)

## Specifications:

- Multi-functioning: Accepts pad locks or cylinder locks.
- Secure: 90-degree tongue angle provides elevated forced entry protection.
- Versatile: transition to a keyed bezel lock without needing to replace the latch.
- Compatibility: Roll-up, Swing, and Locker Door compatible.
- Made in the USA
- Available in: Stainless-Steel & Yellow Zinc

