

4

3

2

1

MINIMUM HEADROOM CLEARANCE FOR SRD-YYY-XXX	L1	L2	L3
FOR XXX = 84 AND 96	16"	18"	6"
FOR XXX = 108 AND 120	18"	19"	

REVISIONS			
REV.	DESCRIPTION	DATE	APPROVED
A3	UPDATED FOR 9' WIDE DOOR	10/21/2024	K.WATSON
A4	LOAD TABLE AND REACTIONS ADDED	12/16/2024	K.WATSON

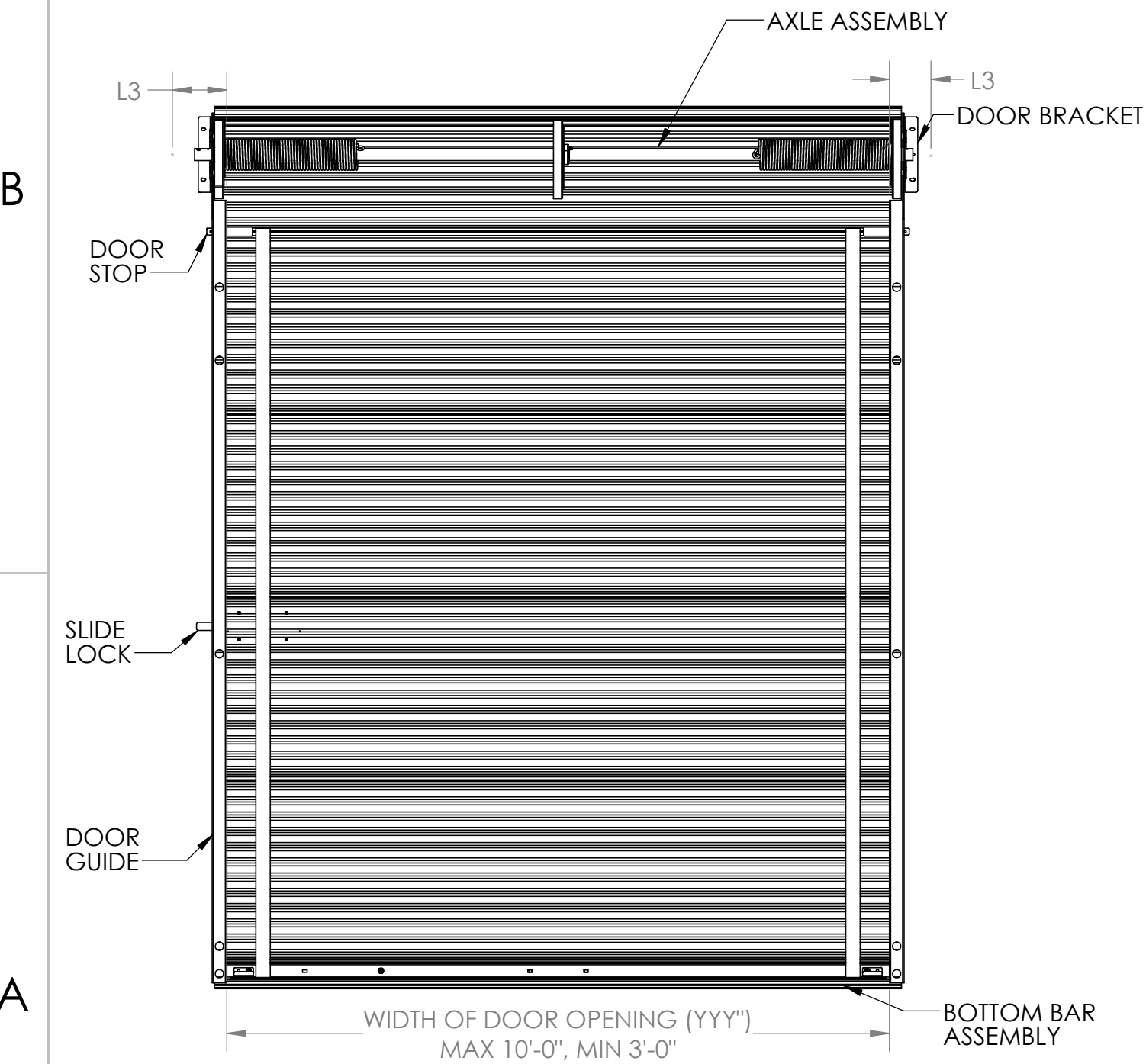

INSIDE ELEVATION



SIDE ELEVATION

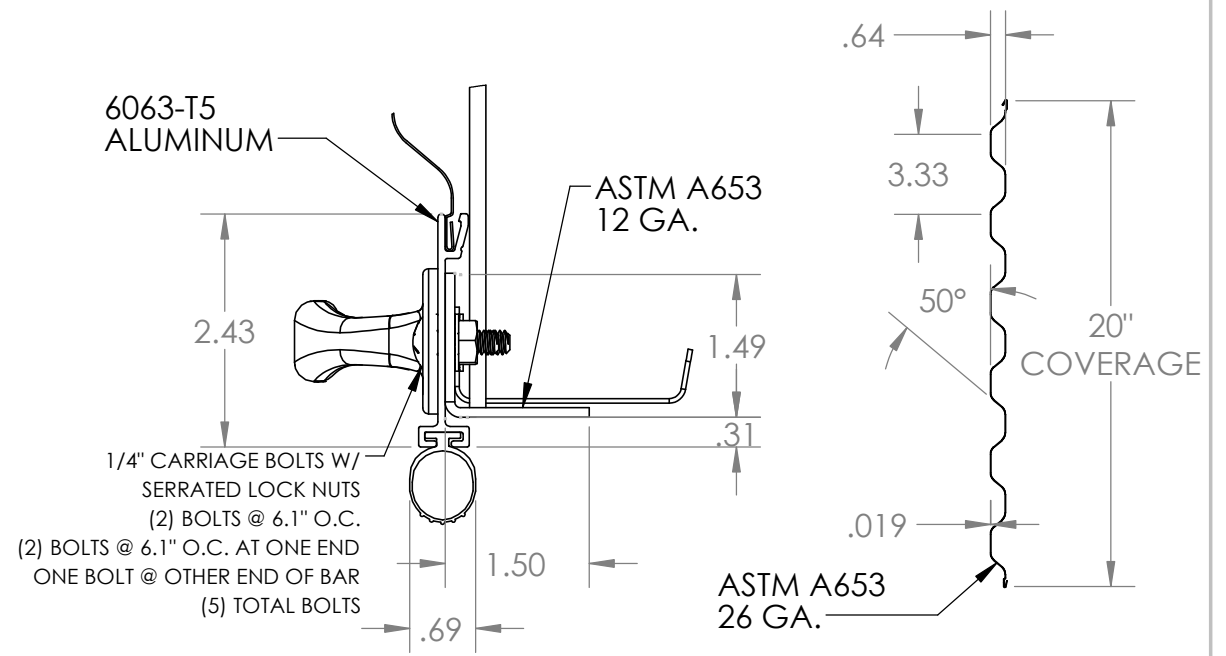

BOTTOM BAR ASSEMBLY DETAIL

DOOR PANEL DETAIL

DOOR WIDTH	DESIGN PRESSURE (PSF)
3'-0"	+22.0/-28.7
3'-6"	+21.7/-28.2
4'-0"	+21.5/-27.8
5'-0"	+21.2/-27.1
6'-0"	+20.9/-26.6
7'-0"	+17.7/-21.9
8'-0"	+13.9/-17.1
8'-8"	+12.1/-14.8
9'-0"	+11.6/-14.2
10'-0"	+9.5/-10.5

DESIGN PRESSURES



**PROPRIETARY AND CONFIDENTIAL**  
 THE INFORMATION CONTAINED IN THIS DRAWING IS THE SOLE PROPERTY OF CENTRAL STATES MANUFACTURING INC. ANY REPRODUCTION IN PART OR AS A WHOLE WITHOUT THE WRITTEN PERMISSION OF CENTRAL STATES MANUFACTURING INC. IS PROHIBITED.

**UNLESS OTHERWISE SPECIFIED:**  
 DIMENSIONS ARE IN INCHES  
 DECIMAL TOLERANCES:  
 X.X ±0.125  
 X.XX ±0.060  
 X.XXX ±0.030  
 ANGULAR: ±2°  
 INTERPRET TOLERANCING PER: ASME Y14.5

**MATERIAL:**  
 VARIES

**FINISH:**  
 VARIES

	NAME	DATE
DRAWN	K.WATSON	10/13/2023
CHECKED	T.ALLEMAN	10/13/2023
ENG APPR.	K.WATSON	10/13/2023

<b>PART NUMBER:</b> <b>MODEL 6500</b>	<b>REV:</b> <b>A4</b>
<b>DESCRIPTION:</b> MODEL 6500 STANDARD ROLL-UP DOOR	
DO NOT SCALE DRAWING	SCALE: 1:16 SHEET 1 OF 2

4

3

2

1

4

3

2

1

1/4-14 X 1" SELF-DRILLING SCREWS

DOOR GUIDE TAB BENT IN INSTALL FOR NOCK-ON, LOCK-ON DESIGN. TABS IN BRACKET INTERLOCK WITH SLOTS IN DOOR GUIDE

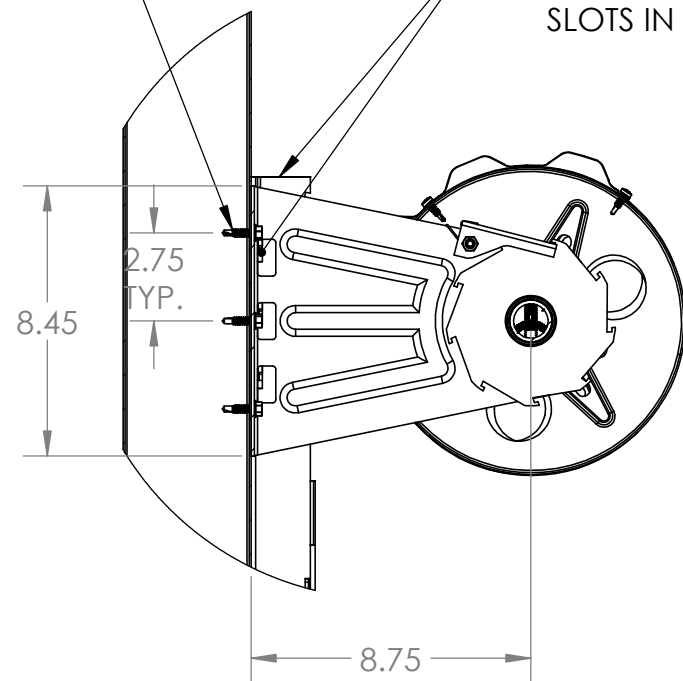

DOOR BRACKET TO STEEL JAMB

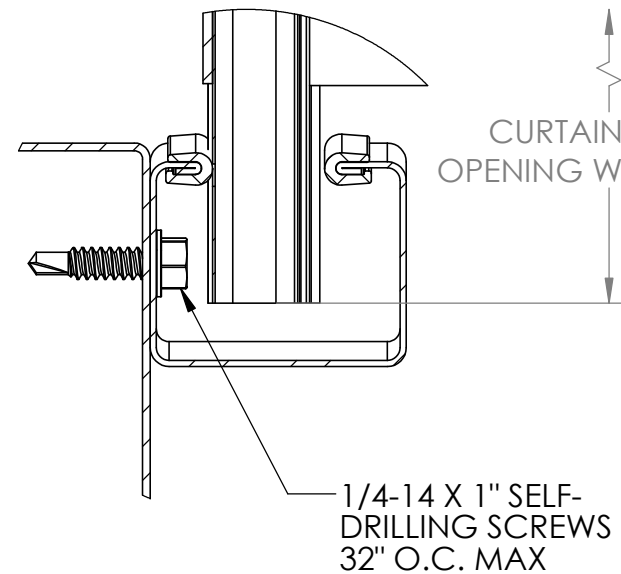

DOOR GUIDE TO STEEL JAMB

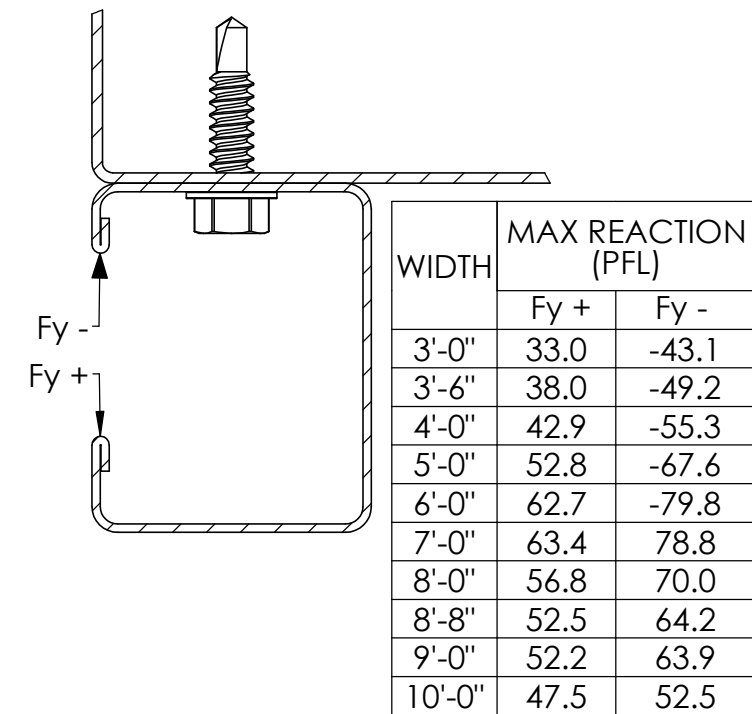

DOOR GUIDE FORCE

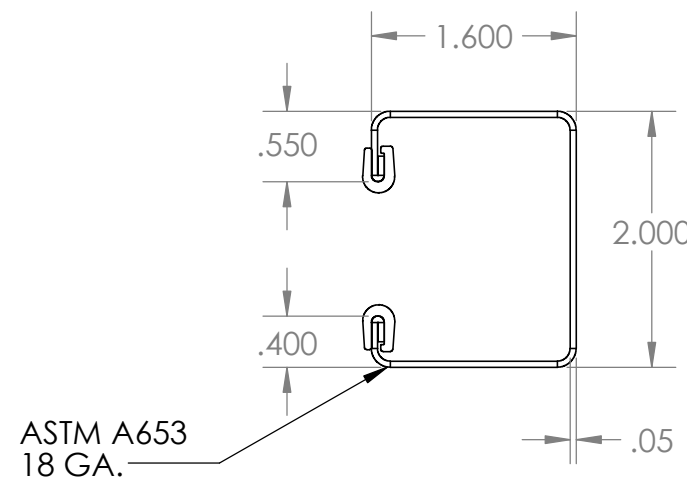

DOOR GUIDE  
DETAIL

This item has been digitally signed and sealed by Bala Sockalingam, PE, on the date indicated.

Printed copies of this document are not considered signed and sealed and this signature must be verified on any electronic copies.

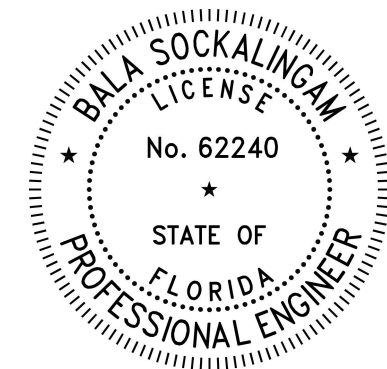

**PROPRIETARY AND CONFIDENTIAL**  
 THE INFORMATION CONTAINED IN THIS DRAWING IS THE SOLE PROPERTY OF CENTRAL STATES MANUFACTURING INC. ANY REPRODUCTION IN PART OR AS A WHOLE WITHOUT THE WRITTEN PERMISSION OF CENTRAL STATES MANUFACTURING INC. IS PROHIBITED.

**UNLESS OTHERWISE SPECIFIED:**  
 DIMENSIONS ARE IN INCHES  
 DECIMAL TOLERANCES:  
 X.X ±0.125  
 X.XX ±0.060  
 X.XXX ±0.030  
 ANGULAR: ±2°

**MATERIAL:**  
 VARIES

**FINISH:**  
 VARIES

	NAME	DATE
<b>DRAWN</b>	K.WATSON	10/13/2023
<b>CHECKED</b>	T.ALLEMAN	10/13/2023
<b>ENG APPR.</b>	K.WATSON	10/13/2023

<b>PART NUMBER:</b> <b>MODEL 6500</b>	<b>REV:</b> <b>A4</b>
<b>DESCRIPTION:</b> MODEL 6500 STANDARD ROLL-UP DOOR	
DO NOT SCALE DRAWING	SCALE: 1:1 SHEET 2 OF 2

4

3

2

1

B

B

A

A